

# If you can, always use a new sterile syringe

If you have to re-use a syringe clean it like this.

Get three clean cups and fill with cold water.

Dissolve a chlorine tablet in one cup.

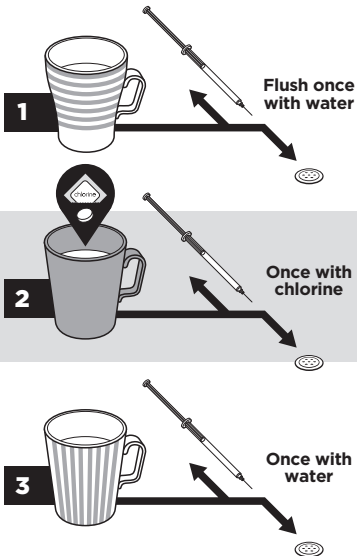

**chlorine**  
**DISINFECTION TABLET**

**Do not swallow**

Dissolve in 1 cup  
(250ml) of water

**Flush syringe:**

Once with water  
Once with chlorine  
Once with water

**EXCHANGE SUPPLIES**

T: 01305 262244

**EXCHANGE**  
SUPPLIES